

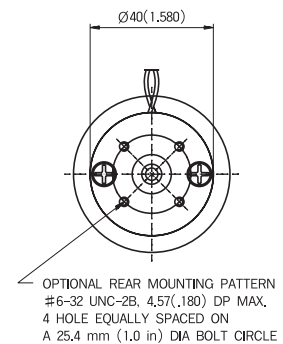

RS4 SERIES COMPACT DC GEARED MOTOR

MOTOR DIMENSION

unit : mm (inch)

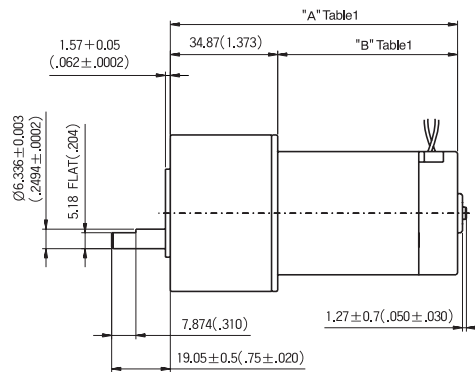
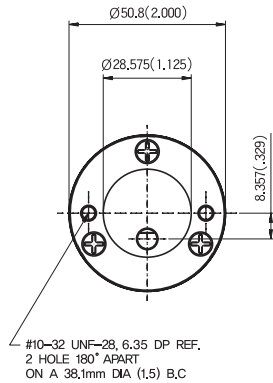

- □ color indicates that the output shaft of the geared motor rotates in the same direction as the output shaft of the motor. Others indicate rotation in the opposite direction.
- Rotational speed based on no-load speed divided by gear ratio. The actual rotation speed is less 2-20% than the displayed value according to the load

GEARED MOTOR DIMENSION (Table1)

unit: mm (inch)

MODEL NO.	"A" DIMENSION	"B" DIMENSION	WEIGHT(kg)/(oz)
RS42□□□□	78.76(3.101)	43.89(1.728)	0.39(13.8)
RS43□□□□	88.29(3.476)	53.42(2.103)	0.43(15.2)
RS44□□□□	93.37(3.676)	58.49(2.303)	0.50(17.6)
RS45□□□□	100.99(3.976)	66.12(2.603)	0.54(19.0)
RS46□□□□	109.88(4.326)	75.0(2.953)	0.58(20.5)

GEAR HEAD RATED LOAD

(at DC 24V)

MODEL	GEAR RATIO	5.9	11.5	19.7	38.3	65.5	127.8	218.4	425.9	728.1	1419.8
RS42□□□□	rpm	1189	610	356	183	107	55	32	16	10	5
	kg-cm	0.9	1.7	2.6	5.0	7.7	15.1	23.2	36.0	36.0	36.0
	N·m (oz.in)	0.084(1.25)	0.164(23.6)	0.253(36.1)	0.493(69.4)	0.758(106.9)	1.479(209.7)	2.275(322.2)	3.530(500.0)	3.530(500.0)	3.530(500.0)
RS43□□□□	rpm	1.016	521	304	156	91	47	27	14	8	4
	kg-cm	1.4	2.7	4.2	8.1	12.5	24.3	36.0	36.0	36.0	36.0
	N·m (oz.in)	0.136(19.4)	0.265(37.5)	0.408(58.3)	0.794(112.5)	1.221(173.6)	2.383(337.5)	3.530(500.0)	3.530(500.0)	3.530(500.0)	3.530(500.0)
RS44□□□□	rpm	1043	535	312	161	94	48	28	14	8	4
	kg-cm	1.4	2.8	4.3	8.4	12.9	25.2	36.0	36.0	36.0	36.0
	N·m (oz.in)	0.141(19.4)	0.274(38.9)	0.422(59.7)	0.821(116.7)	1.263(179.2)	2.465(350.0)	3.530(500.0)	3.530(500.0)	3.530(500.0)	3.530(500.0)
RS45□□□□	rpm	1076	552	322	166	97	50	29	15	9	4
	kg-cm	1.7	3.4	5.2	10.1	15.5	30.2	36.0	36.0	36.0	36.0
	N·m (oz.in)	0.169(23.6)	0.329(47.2)	0.507(72.2)	0.985(140.3)	1.516(215.3)	2.958(419.4)	3.530(500.0)	3.530(500.0)	3.530(500.0)	3.530(500.0)
RS46□□□□	rpm	833	427	250	128	75	38	23	12	7	3
	kg-cm	2.4	4.7	7.2	14.0	21.5	36.0	36.0	36.0	36.0	36.0
	N·m (oz.in)	0.234(33.3)	0.456(65.3)	0.704(100.0)	1.368(194.4)	2.106(298.6)	3.530(500.0)	3.530(500.0)	3.530(500.0)	3.530(500.0)	3.530(500.0)