



200W

INDUCTION MOTOR
 90mm LEAD WIRE TYPE

INDUCTION MOTORS

SIZE mm sq.	Type	Poles	Output (W)	Voltage (V)	Frequency (Hz)	Duty	Rated Load				Starting Torque		Capacitor (uF)
							Current (A)	Speed (rpm)	Torque		(kg-cM)	(N-m)	
									(kg-cm)	(N-m)			
90	S9I200GU S9I200GUCE	4	200	3 ∅ 200	50	Cont.	1.3	1250	16.00	1.600	24.00	2.400	—
					60		1.2	1500	13.40	1.340	20.00	2.000	
	S9I200GT S9I200GTCE	4	200	3 ∅ 220	50	Cont.	1.3	1300	15.00	1.500	30.00	3.000	—
					60		1.2	1550	12.90	1.290	25.00	2.500	

- "CE" marked at the end of model name indicates that it is thermally protected type which has received CE (File NO. E9766002E01, Certificate Institute:TÜV Rhinland) with built-in TP.
- "TP" marked at the end of the model name indicates that it is standard motor with Thermal Protector mounted.
- There is not marked the 'H' type caused by exclusive use.

50Hz

MODEL	GEAR RATIO	3	3.6	5	6	7.5	9	10	12.5	15	18	20	25	30	36	40	50	60	75	90	100	120	150	180	200
		rpm	500	416	300	250	200	166	150	120	100	83	75	60	50	41	37	30	25	20	16	15	12	10	8
S9KH□B	kg-cm	39.0	47.0	64.8	77.8	97.2	117	130	146	175	210	233	262	300	300	300	300	300	300	300	300	300	300	300	300
	N-m	3.813	4.609	6.355	7.626	9.532	11.47	12.75	14.32	17.16	20.59	22.88	25.74	29.42	29.42	29.42	29.42	29.42	29.42	29.42	29.42	29.42	29.42	29.42	29.42

60Hz

MODEL	GEAR RATIO	3	3.6	5	6	7.5	9	10	12.5	15	18	20	25	30	36	40	50	60	75	90	100	120	150	180	200
		rpm	600	500	360	300	240	200	180	144	120	100	90	72	60	50	45	36	30	24	20	18	15	12	10
S9KH□B	kg-cm	32.0	38.3	53.3	64.0	79.9	96.0	107	120	144	173	192	216	259	300	300	300	300	300	300	3000	300	300	300	300
	N-m	3.134	3.760	5.223	6.267	7.384	9.414	10.49	11.75	14.10	16.97	18.83	21.18	25.40	29.42	29.42	29.42	29.42	29.42	29.42	29.42	29.42	29.42	29.42	29.42

- The code in □ of gearhead model is for gear ratio.
- It is the permissible torque of the assembled motor and gearhead.
- ■ color indicates that the output shaft of the geared motor rotates in the same direction as the output shaft of the motor. Others indicate rotation in the opposite direction.
- Rotational speed based on synchronous speed (50Hz:1500rpm, 60Hz:1800rpm) divided by gear ratio. The actual rotation speed is less 2-20% than the displayed value according to the load.
- There is not marked the 'H' type caused by exclusive use.

DIMENSIONS

GEARED MOTOR

* MOTOR MODEL : S9I200G□

* HEAD MODEL : S9□H3B~S9□H200B

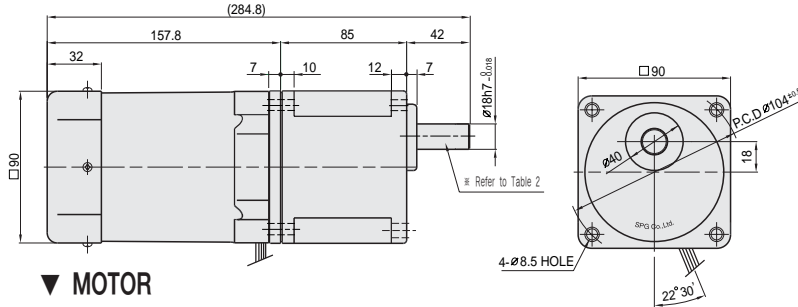

MOTOR

* MOTOR MODEL : S9I200□□

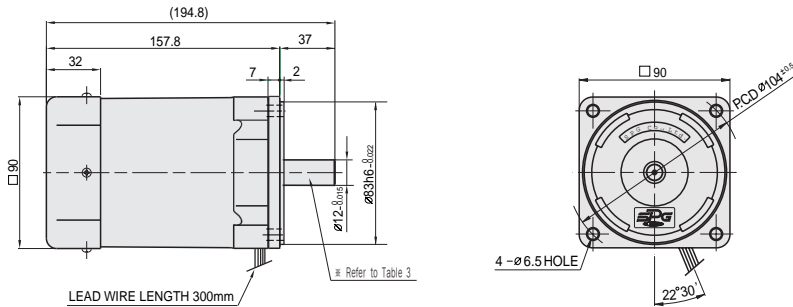

WEIGHT-(Table 1)

PART	WEIGHT(kg)	
MOTOR	3.70	
GEAR HEAD	S9□H3B ~S9□H10B	1.65
	S9□H12.5B ~S9□H20B	1.80
	S9□H25B ~S9□H60B	1.90
	S9□H75B ~S9□H200B	1.95

SPEC for output shaft of gearhead-(Table 2)

MODEL	TYPES OF OUTPUT SHAFT
STRAIGHT TYPE	
S9SH3B ~S9SH200B	
D-CUT TYPE	
S9DH3B ~S9DH200B	
KEY TYPE	
S9KH3B ~S9KH200B	

SPEC for output shaft of motor-(Table 3)

MODEL	TYPES OF OUTPUT SHAFT
GEAR TYPE	
S9I200G□	
STRAIGHT TYPE	
S9I200S□	
D-CUT TYPE	
S9I200D□	
KEY TYPE	
S9I200K□	

KEY SPEC

GEARHEAD	MOTOR

SCHEMATIC DIAGRAMS

The direction of motor rotation is as viewed from the front shaft end of the motor.

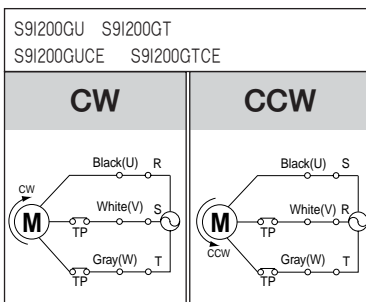

Change the direction of motor rotation only after the motor stops completely. If an attempt is made to change the direction of rotation while the motor is running, the motor may ignore the reversing command or change its direction of rotation after some delay.