



150W

INDUCTION MOTOR
 90mm LEAD WIRE TYPE

SIZE mm sq.	Type	Poles	Output (W)	Voltage (V)	Frequency (Hz)	Duty	Rated Load				Starting Torque		Capacitor (uF)
							Current (A)	Speed (rpm)	Torque (kg-cm) (N-m)		(kg-cm)	(N-m)	
90	S9I150GU S9I150GUCE	4	150	3 ∅ 200	50	Cont.	1.0	1250	11.70	1.170	18.0	1.800	—
					60		0.9	1500	9.70	0.970	15.0	1.500	
	S9I150GT S9I150GTCE	4	150	3 ∅ 220	50	Cont.	1.0	1300	11.30	1.130	22.0	2.200	—
					60		0.9	1550	9.40	0.940	19.0	1.900	

- "CE" marked at the end of model name indicates that it is thermally protected type which has received CE (File NO. E9766002E01, Certificate Institute: TÜV Rhinland) with built-in TP.
- "TP" marked at the end of the model name indicates that it is standard motor with Thermal Protector mounted.
- There is not marked the 'H' type caused by exclusive use.

50Hz

GEAR RATIO	50 Hz																								
	3	3.6	5	6	7.5	9	10	12.5	15	18	20	25	30	36	40	50	60	75	90	100	120	150	180	200	
MODEL	rpm	500	416	300	250	200	166	150	120	100	83	75	60	50	41	37	30	25	20	16	15	12	10	8	7.5
	kg-cm	23.1	27.7	38.5	46.2	57.7	69.3	77.0	86.6	104	125	139	156	187	224	249	300	300	300	300	300	300	300	300	300
	N-m	2.264	2.717	3.773	4.528	5.660	6.792	7.546	8.489	10.24	12.29	13.65	15.36	18.34	21.97	24.42	29.42	29.42	29.42	29.42	29.42	29.42	29.42	29.42	29.42

60Hz

GEAR RATIO	60 Hz																								
	3	3.6	5	6	7.5	9	10	12.5	15	18	20	25	30	36	40	50	60	75	90	100	120	150	180	200	
MODEL	rpm	600	500	360	300	240	200	180	144	120	100	90	72	60	50	45	36	30	24	20	18	15	12	10	9
	kg-cm	23.2	27.8	38.7	46.4	58.0	69.6	77.4	87.0	104	125	139	156	188	225	250	300	300	300	300	300	300	300	300	300
	N-m	2.276	2.731	3.793	4.552	5.689	6.827	7.586	8.534	10.24	12.29	13.65	15.36	18.43	22.06	24.52	29.42	29.42	29.42	29.42	29.42	29.42	29.42	29.42	29.42

- The code in □ of gearhead model is for gear ratio.
- It is the permissible torque of the assembled motor and gearhead.
- ■ color indicates that the output shaft of the geared motor rotates in the same direction as the output shaft of the motor. Others indicate rotation in the opposite direction.
- Rotational speed based on synchronous speed (50Hz:1500rpm, 60Hz:1800rpm) divided by gear ratio. The actual rotation speed is less 2-20% than the displayed value according to the load.
- There is not marked the 'H' type caused by exclusive use.

DIMENSIONS

▼ GEARED MOTOR

※ MOTOR MODEL : S9I150G□
 ※ HEAD MODEL : S9□H3B~S9□H200B

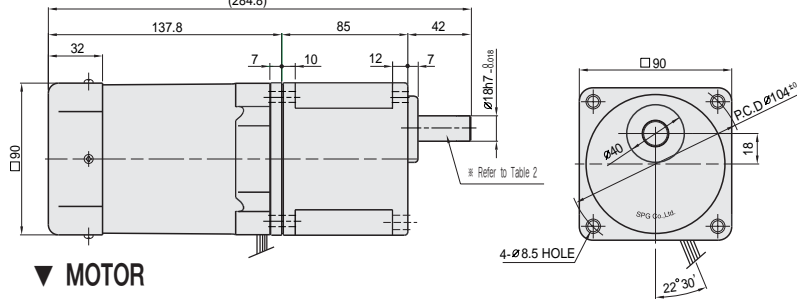

▼ MOTOR

※ MODEL : S9I150□□
 (174.8)

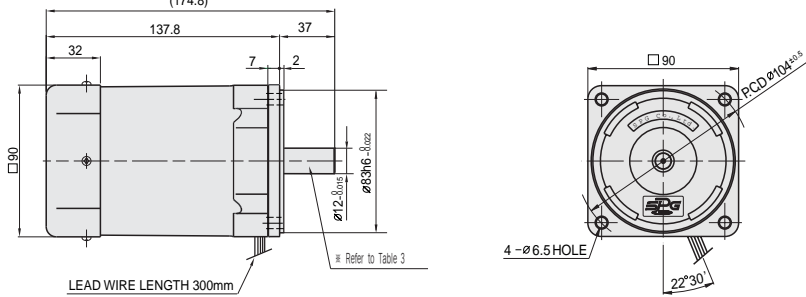

▼ WEIGHT-(Table 1)

PART	WEIGHT(Kg)	
MOTOR	2.93	
GEAR HEAD	S9□H3B ~S9□H10B	1.65
	S9□H12.5B ~S9□H20B	1.80
	S9□H25B ~S9□H60B	1.90
	S9□H75B ~S9□H200B	1.95

▼ SPEC for output shaft of gearhead-(Table 2)

MODEL	TYPES OF OUTPUT SHAFT
STRAIGHT TYPE S9SH3B ~S9SH200B	
D-CUT TYPE S9DH3B ~S9DH200B	
KEY TYPE S9KH3B ~S9KH200B	

▼ SPEC for output shaft of motor-(Table 3)

MODEL	TYPES OF OUTPUT SHAFT
GEAR TYPE S9I150G□	
STRAIGHT TYPE S9I150S□	
D-CUT TYPE S9I150D□	
KEY TYPE S9I150K□	

▼ KEY SPEC

GEARHEAD	MOTOR

SCHEMATIC DIAGRAMS

The direction of motor rotation is as viewed from the front shaft end of the motor.

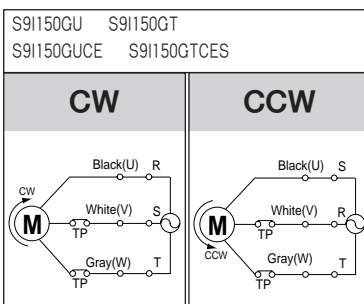

Change the direction of motor rotation only after the motor stops completely. If an attempt is made to change the direction of rotation while the motor is running, the motor may ignore the reversing command or change its direction of rotation after some delay.