

# STANDARD TYPE PERMANENT MAGNET DC MOTOR



## S9D SERIES

### 300W

#### MOTOR DIMENSION

unit : mm(inch)

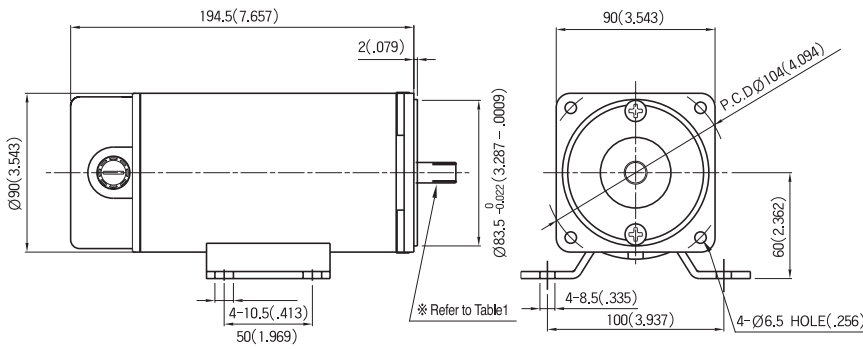

#### CHARACTERISTIC CURVE

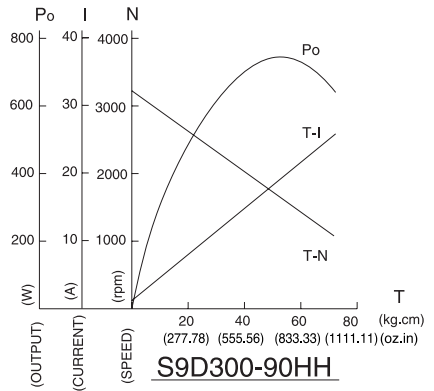

#### SPEC for output shaft of motor-(Table 1)

MODEL	GEARED TYPE	STRAIGHT TYPE	D-CUT TYPE	KEY TYPE
	S9D300-□ HH	S9D300-□ S	S9D300-□ D	S9D300-□ K
TYPE OF OUTPUT SHAFT				

#### CIRCUIT DIAGRAM

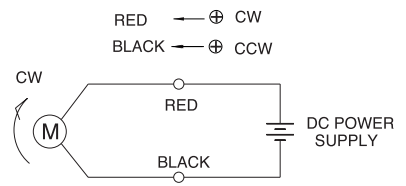

The direction of motor rotation is as viewed from the front shaft end of the motor

#### MOTOR SPECIFICATION

Type	Voltage (V)	Output (W)	No Load		Rated Load			Run Duty (Hr)	Weight (kg(oz))	Remarks
			Revolution (RPM)	Current (A)	Revolution (RPM)	Torque (kg·cm(oz·in))	Current (A)			
S9D300-24□	24	300	3000	MAX.2.0	2500	11.7(162.5)	17.0	1000	5.0(176.4)	
S9D300-90□	90	300	3200	MAX.0.7	2750	10.6(147.22)	4.4	1000	5.0(176.4)	

## GEARED MOTOR SPECIFICATION unit : mm(inch)

### ▼ GEARED MOTOR

- \* MOTOR MODEL : S9D300-□HH
- \* HEAD MODEL : S9□H3B~S9□H200B

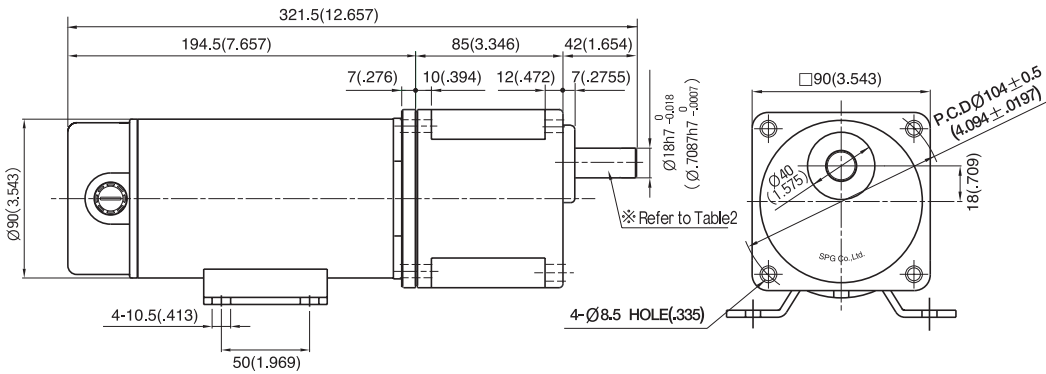

### ▼ WEIGHT-(Table1)

PART		WEIGHT: kg(oz)
MOTOR		5.0(176.4)
GEAR HEAD	S9 □ H3B ~S9 □ H10B	1.65(58.2)
	S9 □ H12.5B ~S9 □ H20B	1.80(63.5)
	S9 □ H25B ~S9 □ H60B	1.90(67.0)
	S9 □ H75B ~S9 □ H200B	1.95(68.8)

### ▼ SPEC for output shaft of gearhead-(Table 2)

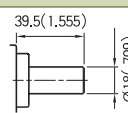
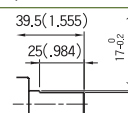
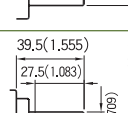
MODEL	TYPES OF OUTPUT SHAFT
STRAIGHT TYPE S9SH3B ~S9SH200B	
D-CUT TYPE S9DH3B ~S9DH200B	
KEY TYPE S9KH3B ~S9KH200B	

### ▼ KEY SPEC

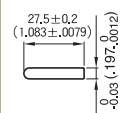
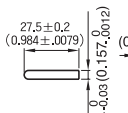
GEAR HEAD	MOTOR
	

## GEAR HEAD RATED LOAD

### 1 S9D300-90HH

GEAR RATIO		3	3.6	5	6	7.5	9	10	12.5	15	18	20	25	30	36	40	50	60	75	90	100	120	150	180	200	
MODEL	rpm	1067	889	640	533	427	356	320	256	213	178	160	128	107	89	80	64	53	43	36	32	27	21	18	16	
	kg-cm	25.8	30.9	42.9	51.5	64.4	77.3	85.9	101.1	121.4	145.7	154.5	180.1	218.5	262.2	300.0	300.0	300.0	300.0	300.0	300.0	300.0	300.0	300.0	300.0	300.0
S9KH□B	N·m	2.524	3.029	4.207	5.049	6.311	7.573	8.414	9.913	11.90	14.27	15.15	17.84	21.41	25.69	29.40	29.40	29.40	29.40	29.40	29.40	29.40	29.40	29.40	29.40	29.40
S9KH□B-S	(oz.in)	(358.3)	(429.1)	(595.8)	(715.2)	(894.3)	(1073)	(1193)	(1404)	(1686)	(2023)	(2146)	(2501)	(3034)	(3641)	(4166)	(4166)	(4166)	(4166)	(4166)	(4166)	(4166)	(4166)	(4166)	(4166)	(4166)

- The code in □ of gearhead model is for gear ratio
- It is the permissible torque of the assembled motor and gearhead
- □ color indicates that the output shaft of the geared motor rotates in the same direction as the output shaft of the motor. Others indicate rotation in the opposite direction.
- Rotational speed based on no-load speed divided by gear ratio. The actual rotation speed is less 2-20% than the displayed value according to the load
- There is not marked the 'H' type caused by exclusive use.